

Bruciatore di gas • Gas burner • Brûleur gaz • Gas-Gebläsebrenner • Quemador de gas

**RIELLO 40 FS5**

COD. **3756631**

TIPO / TYPE / TYP **566T30**

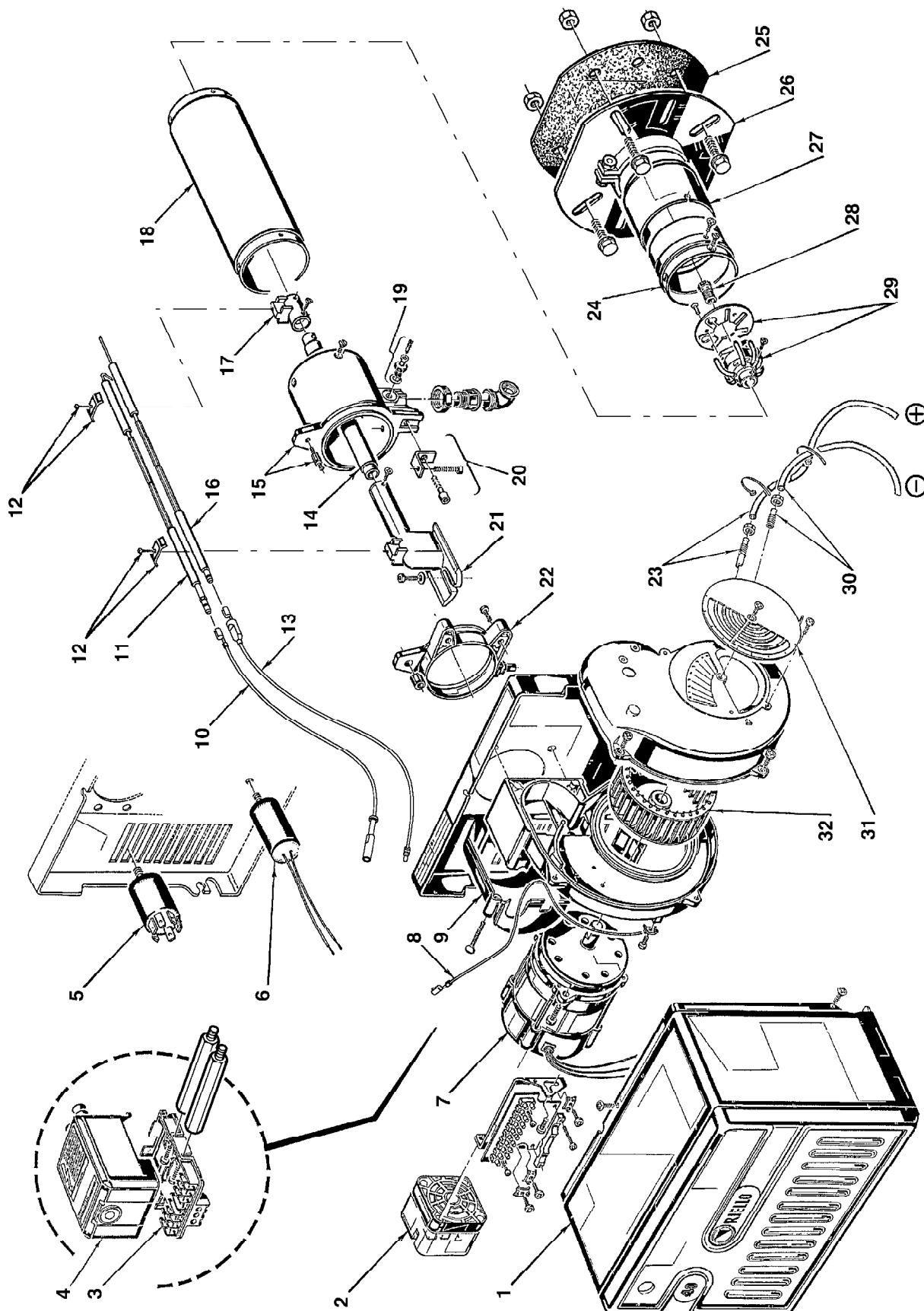

N.	COD.	DESCRIZIONE	DESCRIPTION	DESCRIPTION	BESCHREIBUNG	DENOMINACIÓN
1	3002509	COFANO	COVER	CAPOT	BRENNERHAUBE	ENVOLVENTE
2	3007423	PRESSOSTATO	PRESSURE SWITCH	PRESSOSTAT	PRESSOSTAT	PRESSOSTATO
3	3002307	MORSETTIERA	CONTROL BOX BASE	SOCLE	STECKSOCKEL	ZOCALO
4	3002510	APPARECCHIATURA 525SE/3F	CONTROL BOX 525SE/3F	BOITE DE CONTR. 525SE/3F	STEUERGERÄT 525SE/3F	CAJA DE CONTROL 525SE/3F
5	3008452	FILTRO	SUPPRESSOR	ANTIPARASITE	FUNK-ENSTORHILFE	FILTRO
6	3006686	CONDENSATORE 2 µF	CAPACITOR 2 µF	CONDENSATEUR 2 µF	KONDENSATOR 2 µF	CONDENSADOR 4 µF
7	3008451	MOTORE	MOTOR	MOTEUR	MOTOR	MOTOR
8	3007321	COLLEGAMENTO	LEAD	CABLE DE CONNEXION	VERBINDUNG	CABLE CONEXIÓN
9	3007823	COPERCHIO	COVER	COUVERCLE	DECKEL	TAPA
10	3007879	COLLEGAMENTO A.T.	HIGH VOLTAGE LEAD	CABLE HAUTE TENSION	KABEL ZÜNDELEKTRODEN	CABLES ELECTRODOS
11	3002511	ELETTRODO	ELECTRODE	ELECTRODE	ELEKTRODE	ELECTRODO
12	3007265	CAVALLOTTO	U BOLT	CAVALIER	BÜGELBOLZEN	SOPORTE FIJACIÓN
13	3008490	COLLEGAMENTO SONDA	LEAD	CABLE DE CONNEXION	IONISATIONSKABEL	CABLE CONEXIÓN
14	3007289	TUBO	TUBE	TUYAU	ROHR	TUBO
15	3008608	MANICOTTO	MANIFOLD	MANCHON	GASANSCHLUSS	CUERPO BRIDA
16	3002512	SONDA	PROBE	SONDE	FÜHLER	SONDA
17	3007303	SUPPORTO ELETTRODI	SUPPORT ELECTRODE	SUPPORT ELECTRODES	HALTEBÜGEL	SOPORTE
18	3007284	TUBO PROLUNGA	TUBE	TUYAU	ROHR	TUBO
19	3005447	GRUPPO MISURAZIONE	TEST POINT	PRISE DE PRESSION	MESSNIPPEL	GRUPO TOMA DE PRESION
20	3008607	KIT MONTAGGIO VERTICALE	KIT VERTICAL ASSEMBLY	KIT MONTAGE VERTICAL	KIT VERTIKALE MONTAGE	KIT MONTAJE VERTICAL
21	3006695	GOMITO	ELBOW	COUDE	GASSCHLITTEN	CODO
22	3006687	COLLARE	COLLAR	COLLIER	INNERER FLANSCH	COLLARÍN
23	3006997	RACCORDO E TUBETTO	CONNECTOR AND TUBE	MAMELON ET TUYAU	NIPPEL UND RÖHRCHEN	RACORD - Y TUBO
24	3007281	RACCORDO TESTA DI COMBUSTIONE	COMB. HEAD CONNECTOR	RACCORD GUEULARD	ANSCHLUß	CONEXIÓN TUBO LLAMA
25	3005787	SCHERMO	GASKET	JOINT	DICHTUNG	JUNTA AISLANTE
26	3000929	FLANGIA MOBILE	MOVABLE FLANGE	BRIDE MOBILE	KESSELFLANSCH	BRIDA MOVIBLE
27	3006394	IMBUTO FIAMMA	END CONE	EMBOUT GUEULARD	FLAMMENROHR	TUBO LLAMA
28	3006900	DIFFUSORE	GAS NOZZLE	DIFFUSEUR	GAS VERTEILER	DIFUSÓR
29	3006899	DISTRIBUTORE - ELICA	DISTRIBUTOR-DIFFUSER DISC	DISTRIBUTEUR VIS	VERTEILER-STAUSCHEIBE	DISTRIBUIDOR - DISCO ESTABILIZ.
30	3007588	RACCORDO E TUBETTO	CONNECTOR AND TUBE	MAMELON ET TUYAU	NIPPEL UND RÖHRCHEN	RACORD - Y TUBO
31	3007204	SERRANDA	AIR DAMPER	VOLET AIR	LUFTKLAPPE	REGISTRO DEL AIRE
32	3005708	GIRANTE	FAN	VENTILATEUR	GEBLÄSERAD	TURBINA